

# INTERCONNECTS

## SERIES 416 • 2,54 GRID ELEVATED • DOUBLE ROW STRIPS

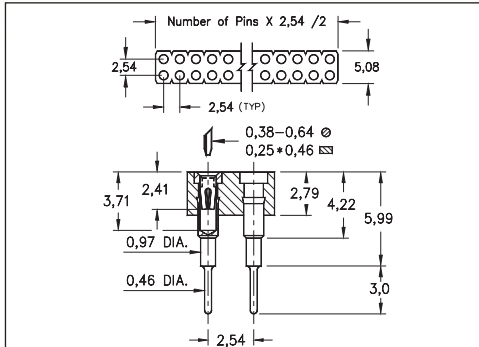

**FIG. 1**

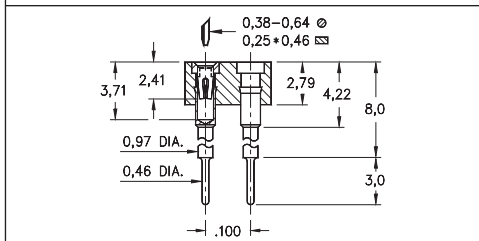

**FIG. 2**

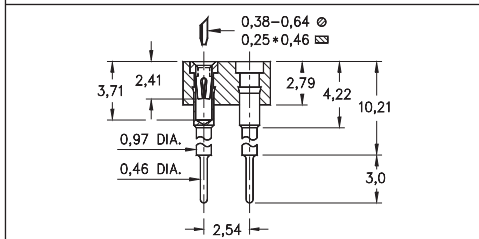

**FIG. 3**

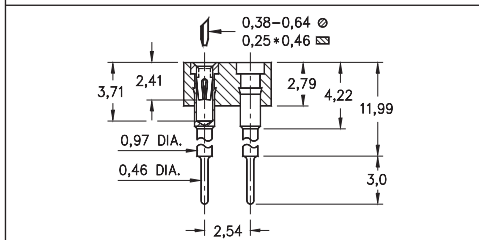

**FIG. 4**

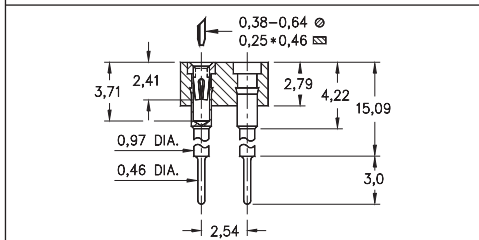

**FIG. 5**

- Elevated socket strips are available in 5 different heights:

416...006 uses pin # 0153-1  
 416...003 uses pin # 0153-2  
 416...007 uses pin # 0153-3  
 416...008 uses pin # 0153-4  
 416...001 uses pin # 0153-5  
 See page 167 for details

- Hi-Rel, 4-finger BeCu #30 contact is rated at 3 amps. See page 253 for details

- Insulators are high temperature thermoplastic, suitable for all soldering operations





### ORDERING INFORMATION

<b>FIG. 1</b>	<b>Series 416...006</b> <b>Standoff Height = 5,99</b>
	416-XX-2--41-006000 Specify number of pins → 04-64
<b>FIG. 2</b>	<b>Series 416...003</b> <b>Standoff Height = 8,0</b>
	416-XX-2--41-003000 Specify number of pins → 04-64
<b>FIG. 3</b>	<b>Series 416...007</b> <b>Standoff Height = 10,21</b>
	416-XX-2--41-007000 Specify number of pins → 04-64
<b>FIG. 4</b>	<b>Series 416...008</b> <b>Standoff Height = 11,99</b>
	416-XX-2--41-008000 Specify number of pins → 04-64
<b>FIG. 5</b>	<b>Series 416...001</b> <b>Standoff Height = 15,09</b>
	416-XX-2--41-001000 Specify number of pins → 04-64

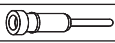

XX=Plating Code  
See Below

For  
Electrical, Mechanical  
& Environmental Data,  
See page 264

<b>SPECIFY PLATING CODE XX=</b>	91	93	41	43	
Sleeve (Pin) 	5,08µm Sn/Pb	5,08µm Sn/Pb	5,08µm Sn	5,08µm Sn	
Contact (Clip) 	0,25µm Au	0,76µm Au	0,25µm Au	0,76µm Au	

